

# Honorlink Smart PIR Sensor Switch

MAF05F

## Notes Before Installation

1. Wi-Fi Only support a 2.4GHz network (802.11 b/g/n)
2. Neutral wire Required.
3. basic electrical wiring knowledge or experience required , or please consult a professional electrician
4. Never connect the neutral wire to any switch wires
5. ON/OFF Button also can be used as reset button, long press to reset your smart switch to factory defaults. Only do this if you are sure you want to erase all your settings

## Specifications

Type	Smart PIR Sensor Switch
Model	MAF05F
Power supply mode	Neutral+Live Wire
Input	AC100-120V ~ 60Hz
Rated Power	INC:600W(Max) LED:150W(Max)
Wireless Frequency	2.4GHz
Wireless Standard	IEEE802.11 b/g/n

## Indicator light meaning

Indicator	Status	Description
White	Flash Rapidly	Ready for connection (Default Mode Only)
White	Flash Slowly (once every 3s)	Ready for connection (DIP Mode Only)
White	OFF	Turn the light off
Red	On	Turn the light on
White	Flash Slowly	Networking

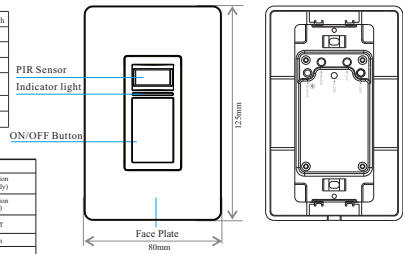

- Safety Notice:**
- Cut off the power before installation
  - Please use it only when it's installed with RCD or current leakage protector at home
  - A neutral wire is needed to power the switch.

## Installation Guide

### STEP.1

Turn off circuit breaker  
Find your light's control in your circuit breaker and turn it off. Then make sure the power is off by flipping your switch a few times.

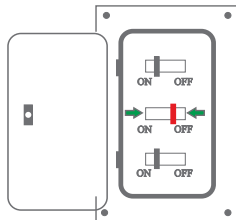

### STEP.2

Find the neutral wire  
In the wall cassette, look for one or more white wires secured with a wire nut. Do you have a neutral wire?

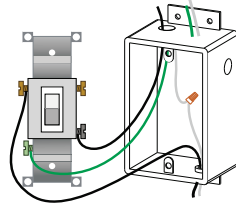

**!** If you can't find neutral wire  
Please change another wall cassette. to find a neutral wire, if you really can't find out a neutral wire in your wall cassette. please contact professional electrician to help you.

### STEP.3

### 3-Way Switch Diagram(Single)

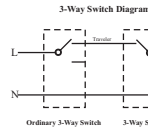
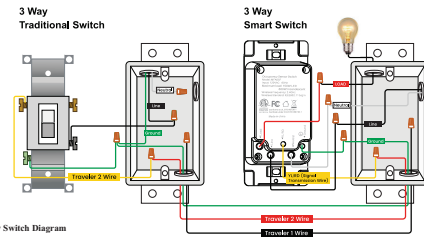

Usually:  
White represents neutral wire  
Black represents live wire  
Red represents load wire  
Yellow represents signal transmission wire

### STEP.3

### 3-Way Switch Diagram(Double)

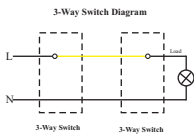
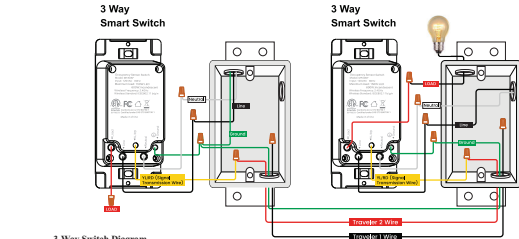

Usually:  
White represents neutral wire  
Black represents live wire  
Red represents load wire  
Yellow represents signal transmission wire  
Two 3-way switches can be replaced with each other

### Switch Can Replace 3 Way or Single Pole Switch

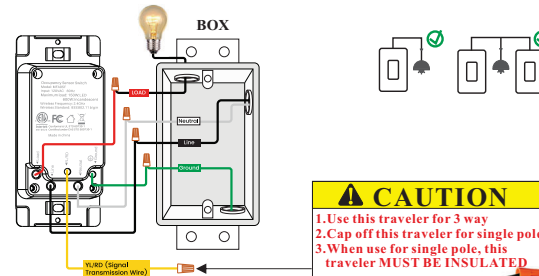

**CAUTION**

1. Use this traveler for 3 way
2. Cap off this traveler for single pole
3. When use for single pole, this traveler MUST BE INSULATED

### Installation Tips:

1. The Most important to mark the Common & Traveler wires before you remove any from the old switch
2. There is no standard for wire colors, the wire colors for travelers & common could be any color

### STEP.4

Turn on circuit breaker  
Turn on your switch's power from the circuit breaker. Press the switch a few times to make sure it works.

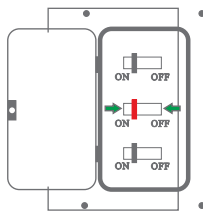

### STEP.5

Check the Wi-Fi light  
Tap NEXT when the Wi-Fi indicator light blinks

Indicator light rapidly blinks  
(2 times per second)

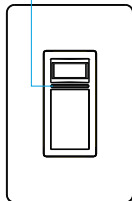

### Install the "Honorlink" APP

Step A. Find out "Honorlink" app in Apple app store, Google Play, or scan the QR code below and install it.



The free app "Honorlink" is compatible with mobile devices that support IOS8.0 above, Android 4.4 above

Step B. Enter the register interface, input the email address/phone number for getting the verification code to register an account. Please just login if you already have a Honorlink account.

**Step C:Add The Occupancy Sensor Switch To Honorlink APP**

Note: This Occupancy Sensor Switch can only support 2.4G network and can't work with 5G network. Please check if your home network is 2.4G and make sure that your phone has been connected to the 2.4G WiFi router.

**Bluetooth automatic link mode (Default Mode)**

(Need to turn on the phone's Bluetooth function)

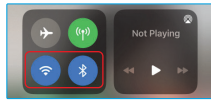

**Step 1.** Bluetooth function turn on the phone's

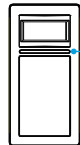

Indicator light rapidly blinks (2 times per second)

**Step 2.** Enter pairing mode: When the product first powers on, the indicator of LED light is fast flashing state as factory default. (2 times in 1 second)

**Note:** If the indicator light is in another state, you need to reset the devices. Please keep pressing the button until the indicator light is flashing quickly

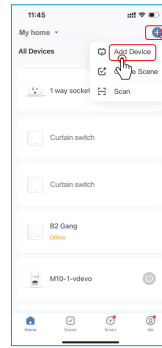

**Step 3.** Tap **+** button on top right corner to add device,

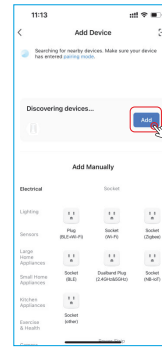

**Step 4.** Discovering devices

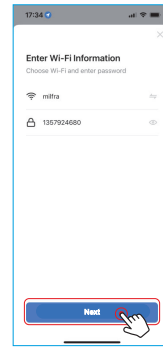

**Step 5.** Enter Wi-Fi password to join your network

8

9

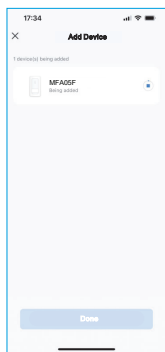

**Step 6.** Wait till device is connected successfully

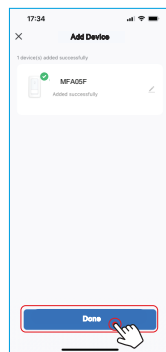

**Step 7.** Click to enter Control interface

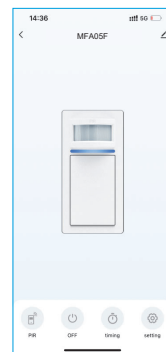

**Step 8.** Device control interface

10

**Step C:Add The Occupancy Sensor Switch To Honorlink APP**

Note: This Occupancy Sensor Switch can only support 2.4G network and can't work with 5G network. Please check if your home network is 2.4G and make sure that your phone has been connected to the 2.4G WiFi router.

**AP Mode (Alternative)**

(In this mode, please turn off the Bluetooth function first)

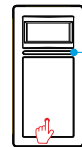

Indicator light slowly blinks (1 time every 3 second)

**Step 1.** Enter pairing mode: The indicator light is in quick connect mode, press any button until the indicator light flashes slowly

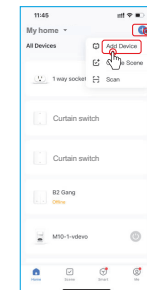

**Step 2.** Tap **+** button on top right corner to add device,

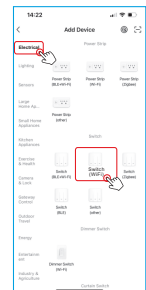

**Step 3.** Electrical Tap Switch (Wi-Fi)

11

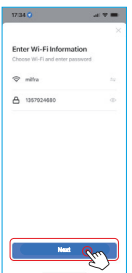

**Step 4.** Enter Wi-Fi password to join your network

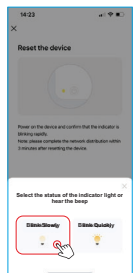

**Step 5.** Tap select Blink Slowly



**Step 6.**



**Step 7.** SmartLife-XXXX

12

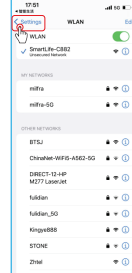

**Step 8.**

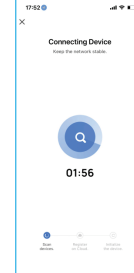

**Step 9.**

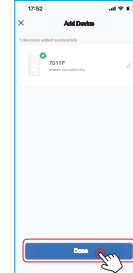

**Step 10.** Click to enter Control interface



**Step 11.** Device control interface

13

**Step D: Give a name to the Occupancy Sensor Switch and tap "Completed". you will find the device you've named is shown on the app home page. Tap the device to enter the setting page.**

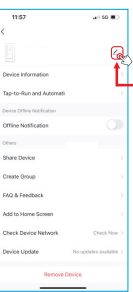
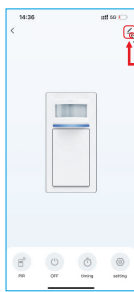

Click Modify device name.

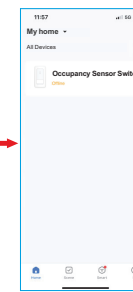

14

1. Forcefully quit and re-start the "Honorlink" APP then checking if that fixes the issues.
2. Unplug your router and plug it back to reboot it, then check if that fixes the issues.

**Q: After dimmer installed, failure to pair APP**

- A-1: Is the position of the installed dimmer covered by Wi-Fi? Or is it far from the router? or the signal is weak? Make sure that the position where the dimmer is installed can receive the Wi-Fi signal normally.
2. Please confirm that the entered Wi-Fi password is correct.
3. Please confirm that the Wi-Fi router is 2.4GHz. (Device does not support 5GHz)
4. If all the above informations are correct but still failure to get connected, please re-pair with AP mode.

**FCC NOTE:**  
This device complies with Part 15 of the FCC Rules. Operation is subject to the following two conditions:  
(1) this device may not cause harmful interference,  
(2) this device must accept any interference received, including interference that may cause undesired operation. The manufacturer is not responsible for any radio or tv interference caused by unauthorized modifications or change to this equipment. Such modifications or change could void the user's authority to operate the equipment. This equipment has been tested and found to comply with the limits for a Class B digital device, pursuant to part 15 of the FCC Rules. These limits are designed to provide reasonable protection against harmful interference in a residential installation. This equipment generates, uses and can radiate radio frequency energy and, if not installed and used in accordance with the instructions, may cause harmful interference to radio communications. However, there is no guarantee that interference will not occur in a particular installation. If this equipment does cause harmful interference to radio or television reception, which can be determined by turning the equipment off and on, the user is encouraged to try to correct the interference by one or more of the following measures:

- Reorient or relocate the receiving antenna.
- Increase the separation between the equipment and receiver.
- Connect the equipment into an outlet on a circuit different from that to which the receiver is connected.
- Consult the dealer or an experienced radio/TV technician for help. RF warning statement:  
To maintain compliance with FCC's RF exposure guidelines, this equipment should be installed and operated with a minimum distance of 20cm between the radiator and your body.

English  
7.3-2(a)

TO REDUCE THE RISK OF OVERHEATING AND POSSIBLE DAMAGE TO OTHER EQUIPMENT, DO NOT INSTALL TO CONTROL A RECEPTACLE, A MOTOR OPERATED APPLIANCE, OR A TRANSFORMER-SUPPLIED APPLIANCE.

15