

10 Factory reset

Press for 10s the program button on the motor, then release it when it lights on the second time (it will light off after 3s), the motor is reset and direction is changed

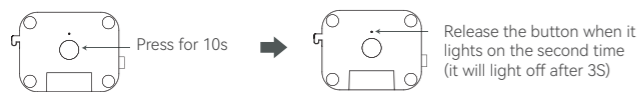

11 Dimming of blinds

1.Press the buttons of dimming, the blinds will turn as you need
2.Press the button of rotating 90°, the blinds will do as it should



12 Switch speeds

Three speeds available. The vibrating time of the motor corresponds to current speed grade;

To slow down the motor: press 5 times the learning button back of the remote, then press CLOSE button;

To speed up the motor: press 5 times the learning button back of the remote, then press OPEN button



Speeds description:

Grades	Description	Reaction of the motor
I	60RPM	Once speed set, the motor vibrates once
II	80RPM	Once speed set, the motor vibrates twice
III	100RPM	Once speed set, the motor vibrates three times

13 Pull-to-start function

The pull-to-start function is available in this motor. The blinds will open or close automatically when pulling them slightly

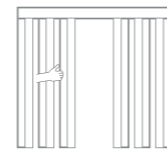

*Manual function is also supported when power off. You can open or close the blinds by pulling them

Problems may meet

No.	Problems	Solutions	No.	Problems	Solutions
1	The motor doesn't work	Check the power supply	5	Blinds stop frequently or can't run to the border	Delete the limits and reset them
2	The remote cannot control the motor	Change the battery	6	Blinds run not smoothly when pulling	Check if there's sth stuck in the track
3	The remote can't control in the right directions	Change the direction of the motor	7	Blinds don't stop when obstacle detected	1.Check the screws to fix the drive pulley; 2. Check the length of belt
4	The blinds can't close completely	1.Check the direction; 2. Check the limits			

Harmful materials

Components	Harmful materials					
	Pb	Hg	Cd	Cr (VI)	PBB	PBDE
Plastic parts	○	○	○	○	○	○
Metal parts	○	○	○	○	○	○
Motor	×	○	○	○	○	○
PCB board	×	○	○	○	○	○
Package	○	○	○	○	○	○

This form is drafted in accordance with the rules specified in SJ/T 11364-2014.

O: indicates that the content of the hazardous substance in all homogeneous materials of the part is below the limit requirements stipulated in GB/T26572.

X: indicates that the content of the hazardous substance in at least one homogeneous

Note: the hazardous substance in the homogeneous can't be replaced due to global level of technological development

Environmental protection use period: 10

The number in this logo indicates that the environmental protection use period of the product under normal use is 10 years. During this period, the hazardous substance in the electronic products won't leak out or mutate under normal use, products usage won't cause serious environmental pollution, personal injury or property damage.

HL-DCM01

INSTRUCTION MANUAL



Double engines



Dimming same time with opening/closing



Pluggable smart module

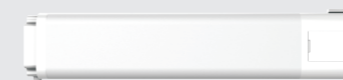

- Please read carefully the instruction manual before use
- The company reserves all rights for final explanation of the instruction
- Product appearance and specifications are subject to change without notice

Package



vertical blinds motor

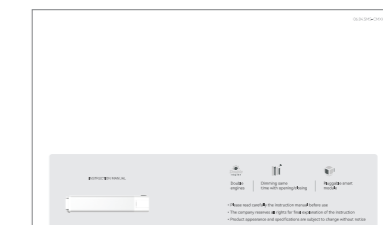

instruction manual

Dimensions

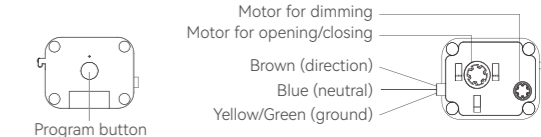
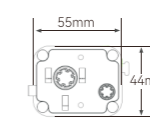
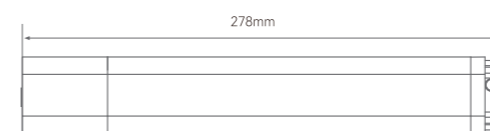

Technical parameters

Model	HL-DCM01	Frequency	50/60Hz
Torque	1.2Nm	Rated power	18W
Blinds moving speed	9cm/s	Rated current	0.08A
Input voltage	100-240V	Load	30kg

Weight	0.88kg	Continuous operating time	12min
Length	278mm	Cable	3 wires
Insulation grade	Class B	Pluggable smart module	supported
Protection index	IP40	Remote control	supported

Description of remote

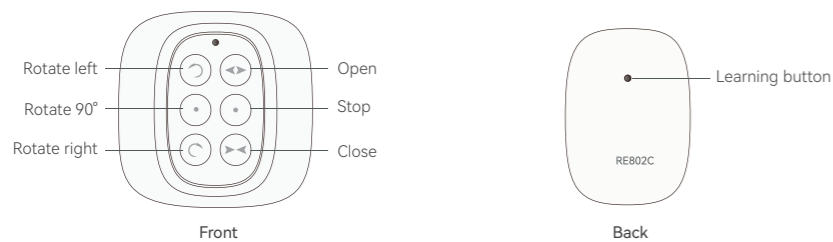

Whole set components

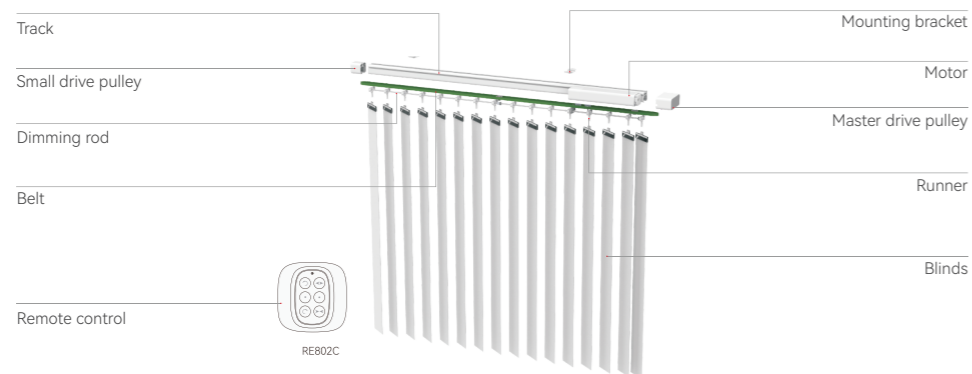

Note: the whole set excludes the blinds in the photo which just help to show the effect

Core competency

1.This motor is compatible with different modules such as Tuya(WiFi/ZigBee), Tmall Genie, Xiaoai, Xiaoyi, Xiaodu, etc.

2.It could be controlled by voice devices, Apps, remote controls, etc.

3.Except it's patented structure, this motor also contains double engines which allow it dimming and opening/closing at the same time.

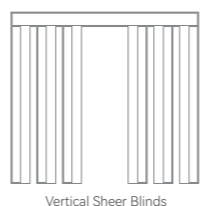

Vertical Sheer Blinds

Note:
1.Some smart systems require using gateway or third party Apps

Cautions:
1.Please read carefully this instruction before use
2.Before installation, please make sure that all the wires to be connected have a switch which conforms to overvoltage category III
3.If power supply damaged, please ask for help from professionals to avoid danger

Operating instruction

Installation and disassembling:

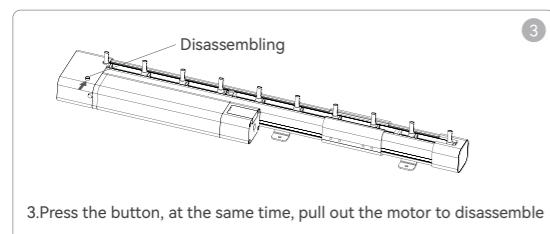
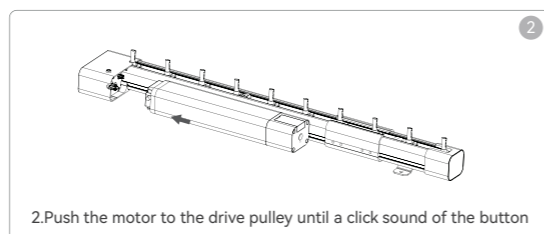
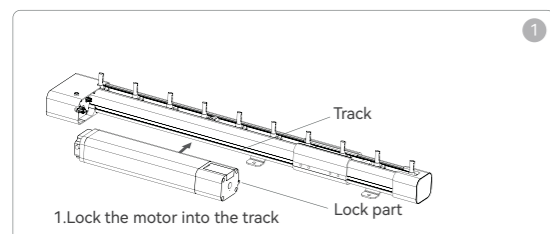

1 Pair remote

Press once the program button on the motor, and press once the learning button back of the remote, the motor will turn back and forth, motor and remote paired



3 Set opening limit

Press OPEN button, the blinds move to a favorite position, and press stop. Short press twice the learning button back of the remote, and press once the OPEN button, the motor turns back and forth. Opening limit set.



5 Set limits automatically

1.Press OPEN, the blinds run to border and stop due to obstacle detected, opening limit is set
2.Press CLOSE, the blinds run to middle and stop due to obstacle detected, closing limit is set

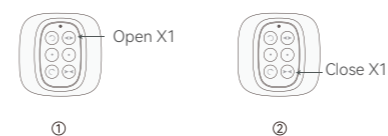

7 Delete limits

A.Delete limits by obstacle detection function:
once obstacle detected, the previous limits will be deleted and new limits will be set

B.Delete limits by program button:
long press for 5s the program button of the motor, release the button when the indicator lights up (it will light off after 3s). The limits all deleted.



C.Delete limits by remote
Delete the opening limit: press 4 times the learning button back of the remote, and press OPEN, the motor turns back and forth, opening limit deleted.



Delete the closing limit: press 4 times the learning button back of the remote, and press CLOSE, the motor turns back and forth, closing limit deleted.



2 Change direction

Press 6 times the learning button back of the remote, and press once the CLOSE button, the motor turns back and forth, direction changed.



4 Set closing limit

Press CLOSE button, the blinds move to a favorite position, and press stop. Short press twice the learning button back of the remote, and press once the CLOSE button, the motor turns back and forth. Closing limit set.



6 Set a third limit

A.Set a third limit (by RE802C)
First of all, please make sure that opening and closing limits are set, and then stop the motor when it runs to your favorite position, short press 4 times STOP, the motor turns back and forth, a third limit is set

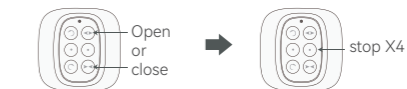

B.Running to the third limit position (RE802C)
Long press STOP for 5s, the motor will run directly to the third limit position

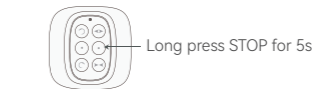

C.Delete the third limit
Once the opening or closing limit is deleted, the third limit will also be deleted

8 Pair a second remote

Press 8 times the learning button back of the remote A, and press once the one back the remote B, the motor turns back and forth. The remote B can also control the motor

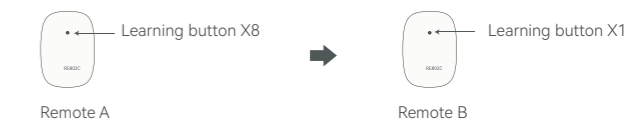

9 Delete the remote paired

Delete the remote paired: press 7 times the learning button back of the remote, and press OPEN once, the motor turns back and forth, the remote is deleted



Delete all the remotes paired: press 6 time the learning button back of the remote, and press OPEN, the motor turns back and forth, all the remotes are deleted

